

Flowmatic® Conceal Sensor Assembly with Stainless Steel Face Plate & Fixed Wall Spout 275

Specification Data Sheet



Features

Electronic Sensor

- Sensor face is designed to be mounted flush into the wall/trough to minimise the growth of dirt or bacteria, combined with the sensor eye and screws that are supplied
- Sensor circuit boards are supplied standard with a lacquer finish to limit the damage that may be caused by moisture
- The multiple time cycle options is able to be adjusted on site, which allows the facility manager the flexibility of adjusting to suit user requirements
- Built in capacitors and easy fit electrical filters to help suppress external noise, and provide a continuous reliable delivery of water
- Bluetooth Connectivity allows facility managers to program-specific hygiene times and other features

Spout

- Angled spout to help minimise the storage of unused water and reduce the spread of Legionella
- Laminar nozzle supplied standard to reduce the risk of Legionella spread
- Bright chrome-plated finish for easy cleaning, added durability and hygiene maintenance

Solenoid

- 24 volt low power usage solenoid to reduce the power usage and costs
- Quiet closing to minimise the impact of water hammer within the plumbing system

To Specify

Galvin Specialised Flowmatic® AS/NZS 3718 and WELS 5* approved wall sensor and outlet combination is designed to be mounted flush into the wall or trough, and provide a low profile finish that helps minimise the build up of dirt or bacteria. Combined with its handsfree operation and self draining laminar flow spouts it minimises the risk of infection for staff and patients. The multiple time cycle options are adjustable on site, allowing the facility manager flexibility to adjust to suit user requirements.

Code:

TZ-FLOWTAPC275 - Flowmatic® Conceal Sensor Assembly with Stainless Steel Face Plate & Fixed Wall Spout 275



A family
owned
Australian
business



Performance Standards & Approvals

- AS/NZS 3718 - WaterMark
- 5 Star WELS rated



Technical Dimensions

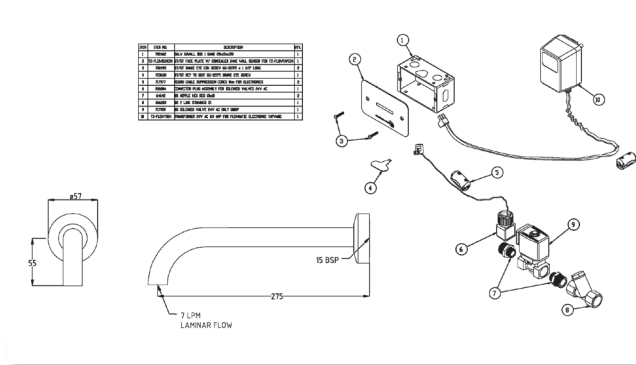

Technical Information

- Inlet: 1/2" BSP - Female
- Outlet: Laminar Flow Aerator
- Headwork: Solenoid
- Working Pressure Range (kPa): 50 Min to 500 Max
- Working Temperature Range (°C): 5 Min - 90 Max
- Nominal Flow Rate (LPM): 5
- Finish: Brushed Stainless Steel Sensor Plate & Chrome Outlet

Maintenance & Cleaning

Galvin Specialised products should be cleaned with a soft damp cloth using only mild liquid detergent or soap and water. Do not use cleaning agents containing a corrosive acid, scouring agent or solvents. Do not use cream cleaners, as they are abrasive. Use of unsuitable cleaning agents may damage the surface. Any damage caused in this way will not be covered by warranty.

Regular maintenance should be carried out in accordance with the installation and troubleshooting guides provided with the product, relevant Australian Standards, local authorities and state codes.

Warranty

Galvin Engineering products are covered under our Manufacturer's Warranty at www.galvinengineering.com.au. Galvin Engineering products must be installed in accordance with the installation instructions and in accordance with AS3500 and the PCA, relevant Australian Standards and local authorities applicable to product being installed. Water and electrical supply conditions must also comply to the applicable national and/or state standards, failing to comply with these provisions may void the product warranty and affect performance of the product.

Whilst all reasonable care has been taken in compiling the information in this document, the designs, dimensions and products shown are indicative only and should not be relied upon without our prior approval. Due to our policy of continuous development, we reserve the right to alter any details of specifications or products without notice. All information, drawings, technical specifications and product designs remains the property of Galvin Engineering Pty Ltd.

Within Australia: **1300 514 074** Outside Australia: P: +61 (0)8 9338 2344
F: +61 (0)8 9338 2340
sales@galvinengineering.com.au
www.galvinengineering.com.au
ABN: 78 008 719 382

A business unit of
GalvinEngineering
the mark of reliability



PERTH | SYDNEY | MELBOURNE | BRISBANE | ADELAIDE | UNITED STATES OF AMERICA | UNITED KINGDOM | NEW ZEALAND