

GalvinCare® CP-BS Ligature Resistant Cistern Push Button Assembly

PRODUCT CODES

- 127837

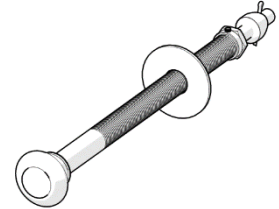

SPECIFICATIONS

- Suits Front Press Cisterns
- Provides both ligature & vandal resistant features to ensure they can be trusted to perform in high risk and secure environments.
- High quality chrome finish for easy cleaning and hygiene maintenance
- Australian made; therefore, spare parts and support are available locally, reducing maintenance and downtime costs.

TECHNICAL DATA

Construction	Brass
Finish	Chrome

NOTE: Galvin Engineering continually strive to improve their products. Specifications may change without notice.

DIMENSIONS

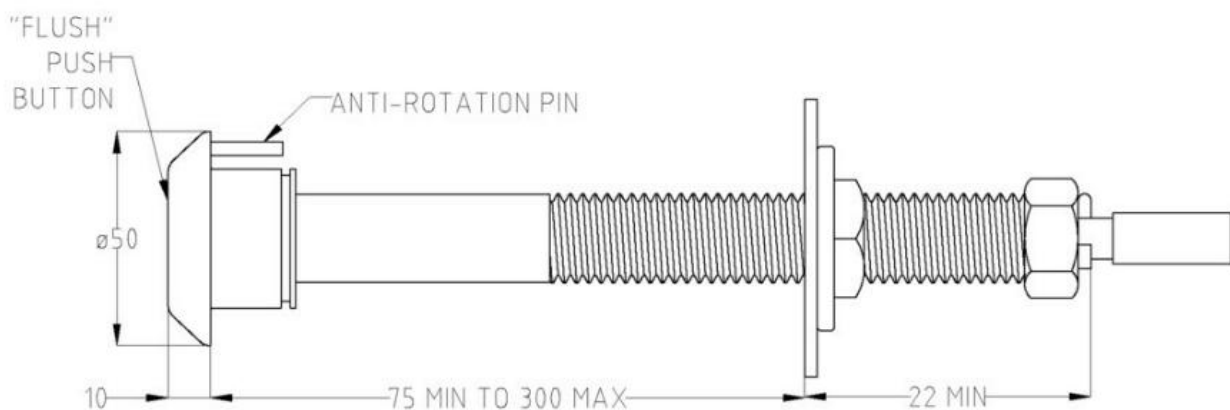

INSTALLATION

INSTALLATION COMPLIANCE: Galvin Engineering products must be installed in accordance with these installation instructions and in accordance with AS/NZS 3500, the PCA and your local regulatory requirements. Water and/or electrical supply conditions must also comply to the applicable national and/or state standards. Failing to comply with these provisions shall void the product warranty and may affect the performance of the product.

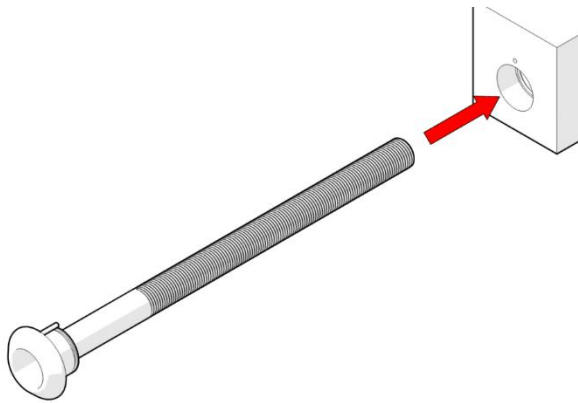

1. Insert Main Body

- Insert main body through wall and mark for cutting if too long. Remove any burrs.
- Consider anti-rotation pin position when inserting.

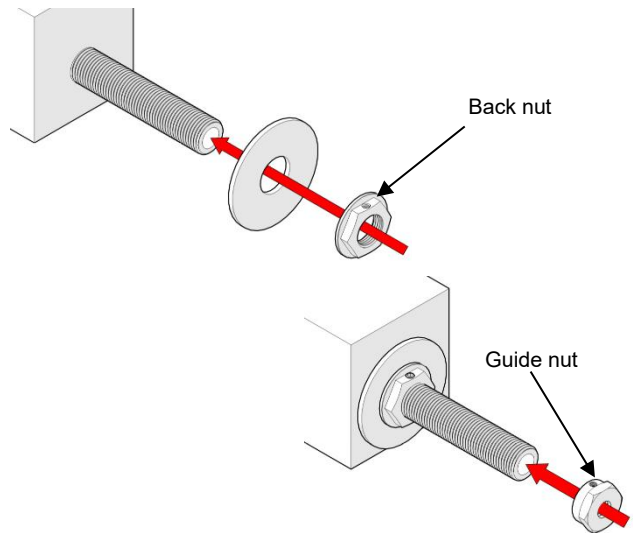

2. Secure Body

- Secure body using the large galvanized washer and flanged backnut
- Fit guide nut at the end and tighten lightly

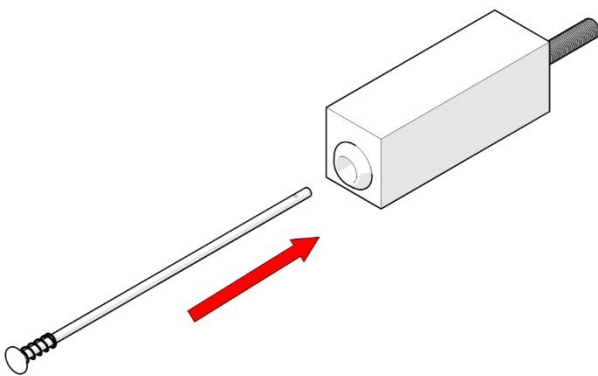

3. Fit Push Rod & Button

- Fit push rod & button through the main body

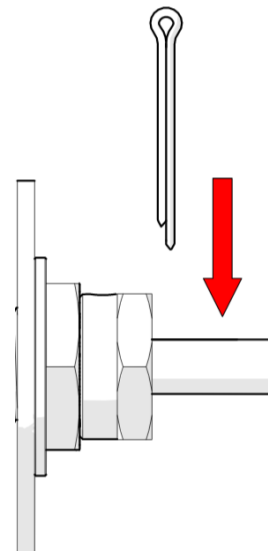

4. Fit cotter pin

- Drill through the extended rod with a Ø3.5mm drill
- Fit the cotter pin through the drilled hole and bend over the ends to stop it from falling out during use

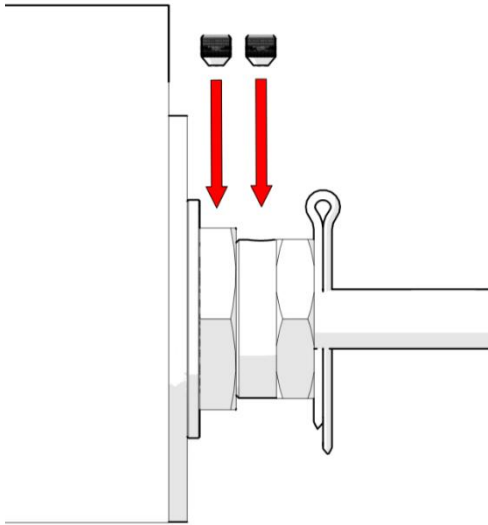

5. Fit Grub Screws

- Fit the supplied grub screws into the guide nut and the flanged back nut and lock securely.

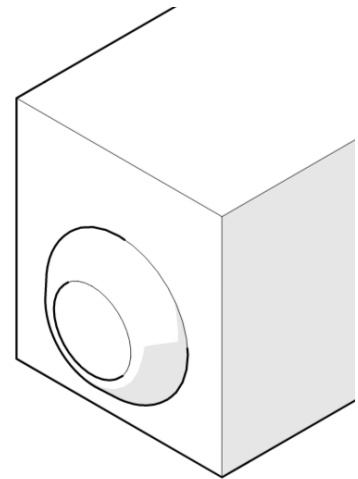

6. Checking and Testing

- Check to ensure the Push Button assembly functions.

WARRANTY

Galvin Engineering products are covered under our Manufacturer's Warranty. Galvin Engineering products must be installed in accordance with the installation instructions and in accordance with AS 3500 and NCC Volume Three, relevant Australian Standards and local authorities applicable to product being installed. Water and electrical supply conditions must also comply to the applicable national and/or state standards, failing to comply with these provisions may void the product warranty and affect performance of the product.

Please visit www.galvinengineering.com.au to view the full warranty, our Installation Compliance and Maintenance & Cleaning information as well as any other additional information.

DEFINITIONS AND DISCLAIMER

Galvin Engineering manufactures a range of products marked as Ligature Resistant or Vandal Resistant. Please visit www.galvinengineering.com.au to read the definition of these terms and the disclaimer that applies to these products.