

Ezy-Wash[®] Hand Held Trigger Spray with 1000mm Hose & Wall Bracket

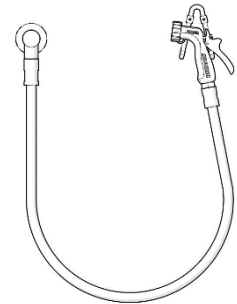

PRODUCT CODE:

- 37405

SPECIFICATIONS

- Galvin Specialised recommends the installation of strainers and pressure reducing valves prior to installing the Hand Held Trigger Spray unit to ensure clean consistent water supply. Debris or poor water quality could cause the trigger to seize or fail to seal.
- Consistent water pressure is required for the trigger spray to operate correctly.
- This product is not to be used with Potable Water.

TECHNICAL DATA

Inlet	1/2" BSP	
Outlet	Trigger Spray	
Headwork	Trigger Spray	
Working Pressure Range (kPa)	Min	5
	Max	500
Working Temperature Range (°C)	Min	5
	Max	65
Nominal Flow Rate (LPM)	N/A	
Finish	Chrome	

NOTE: Galvin Engineering continually strives to improve their products. Specifications may change without notice. Higher temperature or pressures could result in premature failure and void the manufacturer's warranty.

TOOLS REQUIRED

- Adjustable Spanner
- Power Drill
- Screw Driver

PRE-INSTALLATION (MOUNTING DETAILS)

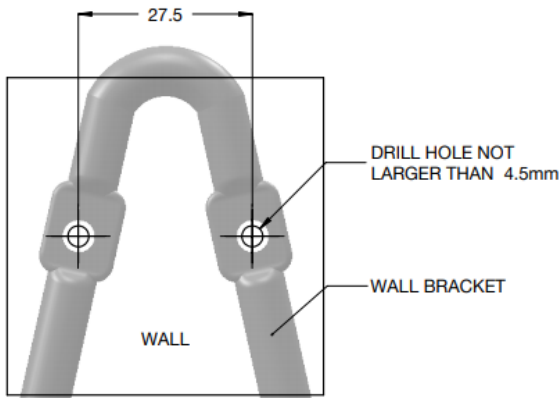

- Suitable screws will need to be sourced by the installer.
- Wall bracket drill holes size and distance as shown.
- Recommended distance of the wall outlet to the wall bracket is between 300-400mm.

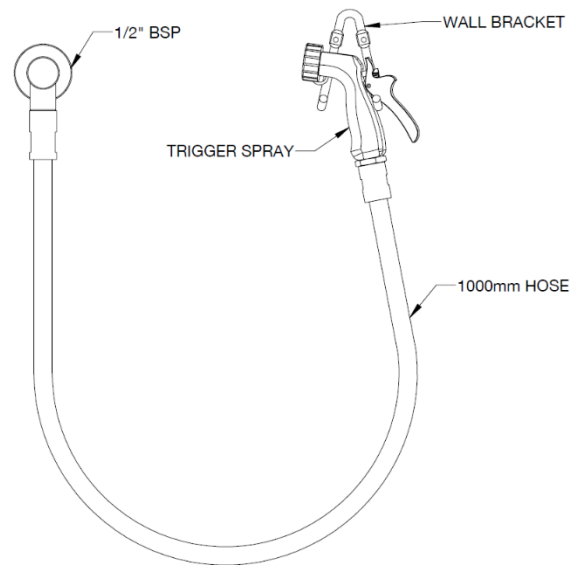

PRE-INSTALLATION

INSTALLATION COMPLIANCE: Galvin Specialised products must be installed in accordance with these installation instructions and in accordance with AS/NZS 3500, the PCA and your local regulatory requirements. Water and/or electrical supply conditions must also comply to the applicable national and/or state standards. Failing to comply with these provisions shall void the product warranty and may affect the performance of the product.

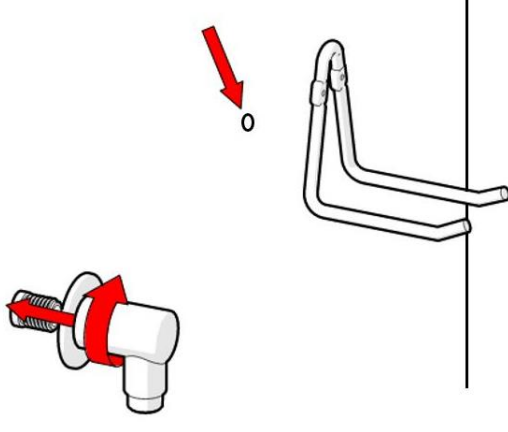

1. Fit wall Outlet and Bracket

- Fit flanged wall outlet as shown ensuring thread tape is used.
- Follow the dimensions in pre-installation mounting details.

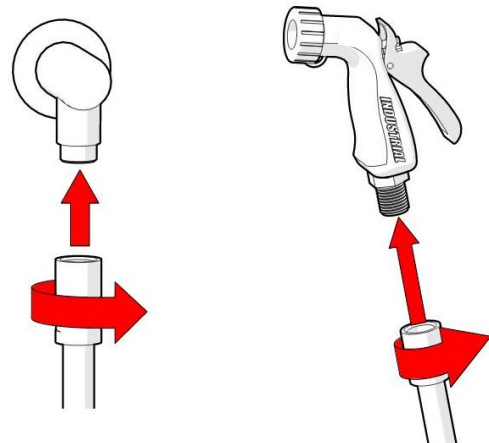

2. Fit hose to wall outlet & trigger spray

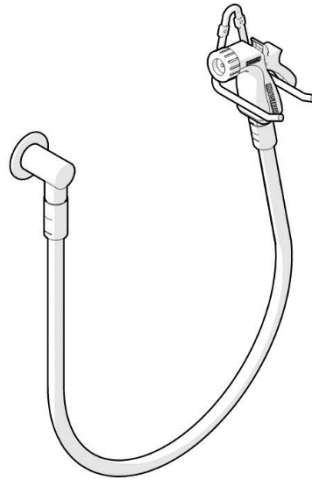

- Fit and tighten hose to wall outlet and trigger spray as shown.



3. Test unit

- Once all connections are secure, turn on water and test the unit for any leaks and correct operation.

WARNINGS

-  For optimum performance it is recommended that the isolation or mains taps are turned off whilst the unit is not in use (overnight etc.), so that the unit is not under mains pressure when unsupervised. Flood damage may occur if a failure occurs whilst the unit is under mains pressure (warranty is void in this instance).
-  Galvin Specialised recommends that the handpiece is periodically serviced by a qualified plumber.

TROUBLESHOOTING (Complete Unit)

PROBLEM	CAUSE	RECTIFICATION
Leaks	Incorrectly installed.	Follow the installation instructions and ensure connections are tight. Inlet and outlet holes must be lined up properly.
Water is not coming out from the spray	Water is turned off	Turn on water
Inconsistent flow	Blocked hose or trigger spray	Remove connections and clean.

WARRANTY

The warranty set forth herein is given expressly and is the only warranty given by the Galvin Engineering Pty Ltd. With respect to the product, Galvin Engineering Pty Ltd makes no other warranties, express or implied. Galvin Engineering Pty. Ltd. hereby specifically disclaims all other warranties, express or implied, including but not limited to the implied warranties of merchantability and fitness for a particular purpose.

Galvin Engineering Pty Ltd products are covered under our manufacturer's warranty available for download from www.galvinengineering.com.au Galvin Engineering Pty Ltd expressly warrants that the product is free from operational defects in workmanship and materials for the warranty period as shown on the schedule in the manufacturer's warranty. During the warranty period, Galvin Engineering will replace or repair any defective products manufactured by Galvin Engineering without charge, so long as the terms of the Manufacturer's warranty are complied with.

The remedy described in the first paragraph of this warranty shall constitute the sole and exclusive remedy for breach of warranty, and Galvin Engineering Pty Ltd shall not be responsible for any incidental, special or consequential damages, including without limitation, lost profits or the cost of repairing or replacing other property which is damaged if this product does not work properly, other costs resulting from labour charges, delays, vandalism, negligence, fouling caused by foreign material, damage from adverse water conditions, chemical, electrical or any other circumstances over which Galvin Engineering has no control. This warranty shall be invalidated by any abuse, misuse, misapplication, improper installation or improper maintenance or alteration of the product

Within Australia: **1300 514 074** Outside Australia: P: **+61 (0)8 9338 2344**

F: **+61 (0)8 9338 2340**

sales@galvinengineering.com.au

www.galvinengineering.com.au

ABN: 78 008 719 382

PERTH | SYDNEY | MELBOURNE | BRISBANE | ADELAIDE

