

# Safe-Cell® Manual Prison Tapware

## PRODUCT CODES:

- 50101C    - 50104C
- 50107C    - 50112C

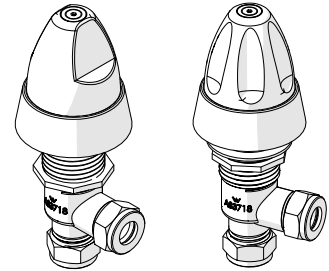

## SPECIFICATIONS

- Designed for maximum protection against vandalism, Safe-Cell® basin/sink assemblies are made from heavy duty components and can be installed from the rear.
- The basin/sink assembly is made of chrome plated brass.
- Quarter turn ceramic disc.
- Machined cold or hot identification button.
- Anti-ligature design.
- Available with either Ezy-Grip or Multi-Grip handle (as shown above).

**IMPORTANT:** All Safe-Cell® wall top assemblies are tested in accordance with AS/NZS 3718 and leave our premises in good working order.

## TECHNICAL DATA

Inlet		1/2" CU/BSP
Outlet		1/2" CU/BSP
Headwork		Ceramic
Working Pressure Range (kPa)	Min	50
	Max	500
Working Temperature Range (°C)	Min	5
	Max	75
Nominal Flow Rate (LPM)		N/A
Finish		Chrome

**NOTE:** Galvin Specialised continually strive to improve their products. Specifications may change without notice.

## TOOLS REQUIRED

- Power drill
- Spanner and hex key
- Thread tape

## Product Installation Guideline

Version 2, 13 June 2017, Page 2 of 4

### PRE-INSTALLATION - MOUNTING DETAILS

- If the mounting holes do not already exist, mark out and drill the hole in the bench/trough to suit your requirements.

*Note: Before installation, all lines must be flushed. We recommend that a line strainer be installed prior to drinking taps to eliminate any foreign material.*

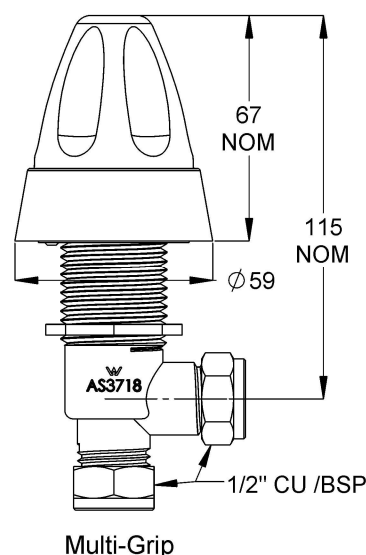
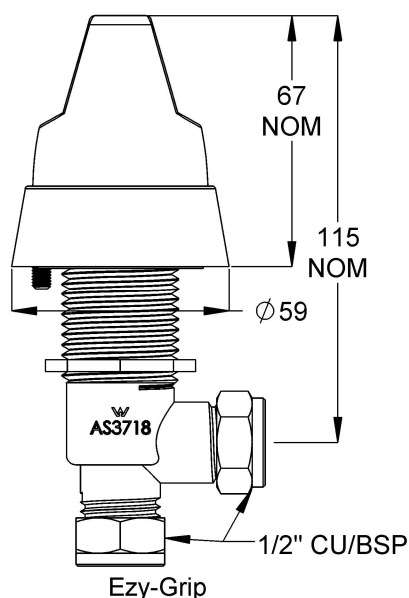
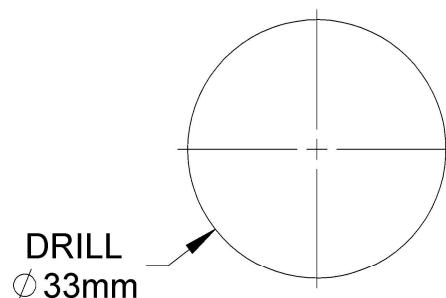

### INSTALLATION

**INSTALLATION COMPLIANCE:** Galvin Specialised products must be installed in accordance with these installation instructions and in accordance with AS/NZS 3500, the PCA and your local regulatory requirements. Water and/or electrical supply conditions must also comply to the applicable national and/or state standards. Failing to comply with these provisions shall void the product warranty and may affect the performance of the product.

**IMPORTANT:** Whilst our product designs take into account a broad range of installation types and surfaces, it is important that surfaces which fixtures are mounted to are flat and free from defect. This is especially important when installing product ranges that have been designed for correctional and health facilities, where special attention is required to minimise ligature points and areas for concealment of contraband. In addition to ensuring the products are fitted securely and in accordance with the following instructions, consideration shall be given to the use of non-pick mastics such as BASF Sonolastic "Ultra" to ensure a high quality and safe installation.



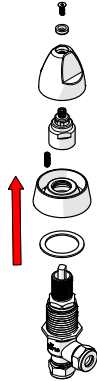

### 1. Disassembly

- Disassemble components, leaving bottom nut on the body.
- Do not remove the ceramic cartridge

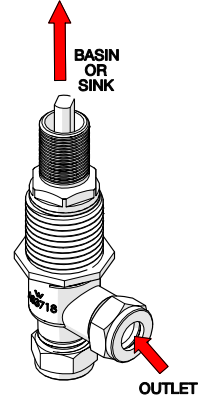

### 2. Fit basin body

- Insert the basin body assembly up through the pre-cut hole.

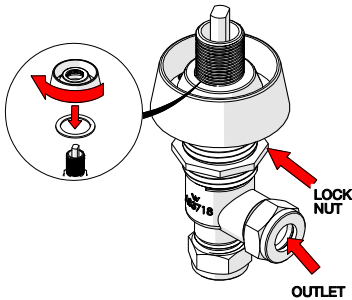

### 3. Fit dress flange

- Fit onto dress flange and hand tighten.
- Tighten bottom nut
- Tighten nuts holding the breach piece.

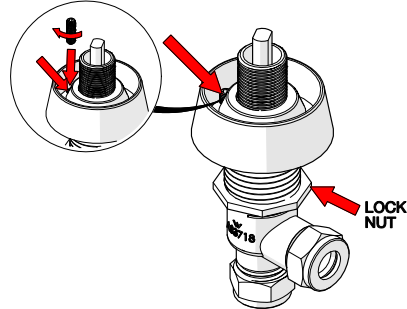

### 4. Fit dress flange with Anti-Rotation pin

- If the anti-rotation option is required, fit dress flange onto body and mark the basin/sink, remove the flange and drill 3/16" hole
- Replace the flange and screw in the grub screw to lock.

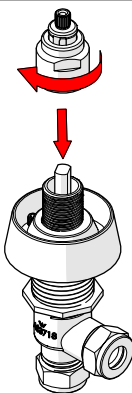

### 5. Fit lock sleeve

- Fit lock sleeve and tighten to lock entire unit in position.

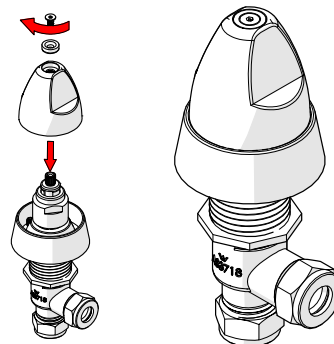

### 6. Assemble handle and test

- Fit handle with tamper proof screw, ensure the correct water temperature identification button is in the handle
- Screw must be tightened before the unit is tested
- Once temperature indicator is fitted, check the operation of the unit and inspect for any leaks.

## TROUBLESHOOTING

PROBLEM	CAUSE	RECTIFICATION
Taps are dripping water	Ceramic cartridge is worn or damaged	Remove and inspect the cartridge, remove debris and /or replace cartridge if damaged
	Tap seat is damaged	Refurbish tap seat using a reseating tool
Water is not flowing from tap	Water is turned off	Turn on water

## WARRANTY

The warranty set forth herein is given expressly and is the only warranty given by the Galvin Engineering Pty Ltd. With respect to the product, Galvin Engineering Pty Ltd makes no other warranties, express or implied. Galvin Engineering Pty. Ltd. hereby specifically disclaims all other warranties, express or implied, including but not limited to the implied warranties of merchantability and fitness for a particular purpose.

Galvin Engineering Pty Ltd products are covered under our manufacturer's warranty available for download from [www.galvinengineering.com.au](http://www.galvinengineering.com.au) Galvin Engineering Pty Ltd expressly warrants that the product is free from operational defects in workmanship and materials for the warranty period as shown on the schedule in the manufacturer's warranty. During the warranty period, Galvin Engineering will replace or repair any defective products manufactured by Galvin Engineering without charge, so long as the terms of the Manufacturer's warranty are complied with.

The remedy described in the first paragraph of this warranty shall constitute the sole and exclusive remedy for breach of warranty, and Galvin Engineering Pty Ltd shall not be responsible for any incidental, special or consequential damages, including without limitation, lost profits or the cost of repairing or replacing other property which is damaged if this product does not work properly, other costs resulting from labour charges, delays, vandalism, negligence, fouling caused by foreign material, damage from adverse water conditions, chemical, electrical or any other circumstances over which Galvin Engineering has no control. This warranty shall be invalidated by any abuse, misuse, misapplication, improper installation or improper maintenance or alteration of the product.