

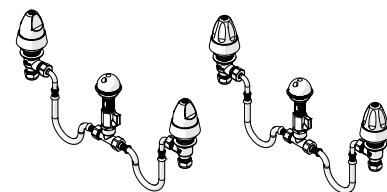

Safe-Cell[®] Prison Tapware

PRODUCT CODE:

- 50113C - 50116C



SPECIFICATIONS

- Designed for maximum protection against vandalism, Safe-Cell[®] basin/sink assemblies are made from heavy duty components and can be installed from the rear.
- The basin/sink assembly is made of chrome plated brass.
- Quarter turn ceramic disc.
- Machined cold or hot identification button.
- Anti-ligature design.
- Available with either Ezy-Grip or Multi-Grip handle (as shown above).

IMPORTANT: All Safe-Cell[®] prison taps are tested in accordance with AS/NZS 3718 and leave our premises in good working order.

TECHNICAL DATA

Inlet	15CU	
Outlet	N/A	
Headwork	Ceramic	
Working Pressure Range (kPa)	Min	50
	Max	500
Maximum Working Temperature (°C)	Min	5
	Max	85
Nominal Flow Rate (LPM)	6	
Finish	Chrome	

NOTE: Galvin Specialised continually strive to improve their products. Specifications may change without notice.

PRE-INSTALLATION

MOUNTING DETAILS

- If the mounting holes do not already exist, mark out and drill the holes in the bench/trough, as shown in rough-in dimensions.

Note: Each supplied flexi hose length is 225mm long. Maximum distance between outlet and body adjustment is 140mm maximum.

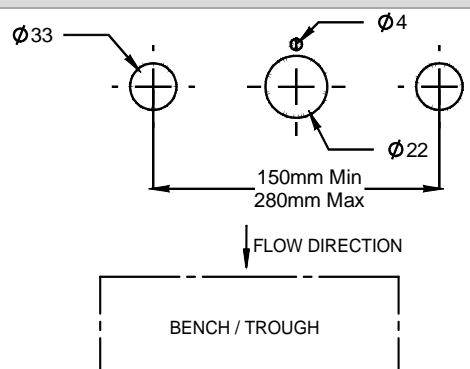

TOOLS REQUIRED

- Power drill
- Spanner or adjustable crescent
- Thread tape/sealant



INSTALLATION

IMPORTANT: Galvin Specialised products must be installed in accordance with these installation instructions and in accordance with AS/NZS 3500, the PCA and your local regulatory requirements. Water and/or electrical supply conditions must also comply to the applicable national and/or state standards. Failing to comply with these provisions shall void the product warranty and may affect the performance of the product.

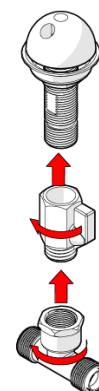
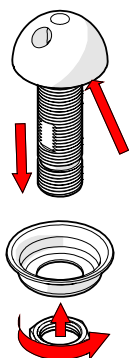

1. Fit basin outlet

- Fit the basin outlet into the bench.
- Ensure the sealing o-ring is placed underneath the outlet and the anti-rotation pin locates properly
- Secure underneath with the supplied cup washer and back nut.

2. Fit isolation regulating valve and t-piece

- Fit isolation valve to the outlet
- Fit supplied t-piece to the isolation valve
- Apply thread sealant or thread tape for sealing. Take care not to over tighten.

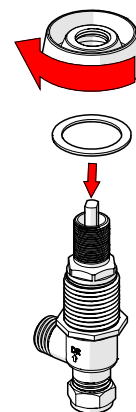
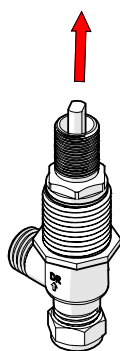

3. Fit basin bodies

- Insert basin body assemblies up through the pre-cut holes.

4. Fit dress flanges

- Fit washer onto dress flange and tighten.
- Screw bottom nut up and tighten.
- Tighten nuts holding the breach piece.

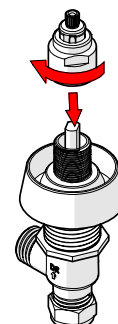
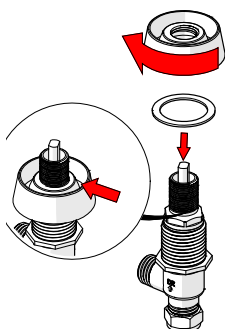

5. Fit dress flange with anti-rotation pin

- If the anti-rotation option is required, fit dress flanges onto body and mark the basin/sink, remove the flange and drill 3/16" hole
- Replace the flanges and screw in the grub screw to lock.

6. Fit lock sleeves

- Fit lock sleeves and tighten to lock entire unit in position.
- Take care not to over tighten.

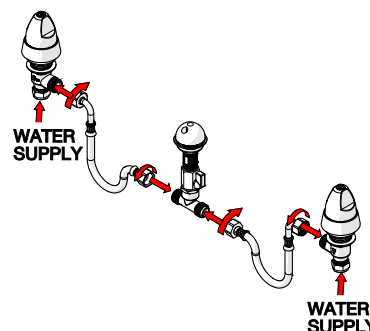
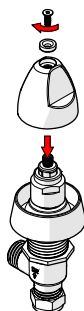

7. Assemble handles

- Fit handles with tamper proof screws, ensure the correct water temperature identification buttons are in the handle
- Screws must be tightened before the unit is tested

8. Fit flexi hose

- Fit flexi hoses to the basin taps and t-piece.
- Connect water supply to basin body inlet.

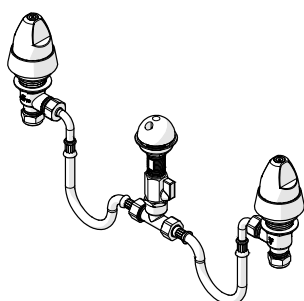

9. Testing

- Turn the handles and ensure that there is flow from outlet.
- Inspect the tap and check for any leaks.
- Adjust flow with isolation valve, so required flow is achieved

TROUBLESHOOTING		
PROBLEM	CAUSE	RECTIFICATION
Inconsistent flow	Blocked flow restrictor	Remove isolation valve, remove flow restrictor & clean with water
	Dirt in the top assembly cartridge	Remove cartridge, clean with water and re-grease spindle if required.
Continuous flow	Top assembly cartridge loose or internally obstructed or damaged.	Remove cartridge, clean with water and re-grease spindle if required.
Water is not flowing from tap	Water supply not on	Turn water on
	Blocked flow restrictor	Remove flow regulator from tap and remove debris. Install an inline strainer to stop further blockages.
Taps are dripping water	Ceramic cartridge is worn or damaged	Remove and inspect the cartridge, remove debris and /or replace cartridge if damaged
	Tap seat is damaged	Refurbish tap seat using a reseating tool
Rate of flow inadequate	The flow restrictor may not be satisfactory due to inadequate supply pressure	Remove flow restrictor and replace with a flow restrictor of different capacity to suit (available from Galvin Specialised)

WARRANTY

The warranty set forth herein is given expressly and is the only warranty given by the Galvin Engineering Pty Ltd. With respect to the product, Galvin Engineering Pty Ltd makes no other warranties, express or implied. Galvin Engineering Pty. Ltd. hereby specifically disclaims all other warranties, express or implied, including but not limited to the implied warranties of merchantability and fitness for a particular purpose.

Galvin Engineering Pty Ltd products are covered under our manufacturer's warranty available for download from www.galvinengineering.com.au Galvin Engineering Pty Ltd expressly warrants that the product is free from operational defects in workmanship and materials for the warranty period as shown on the schedule in the manufacturer's warranty. During the warranty period, Galvin Engineering will replace or repair any defective products manufactured by Galvin Engineering without charge, so long as the terms of the Manufacturer's warranty are complied with.

The remedy described in the first paragraph of this warranty shall constitute the sole and exclusive remedy for breach of warranty, and Galvin Engineering Pty Ltd shall not be responsible for any incidental, special or consequential damages, including without limitation, lost profits or the cost of repairing or replacing other property which is damaged if this product does not work properly, other costs resulting from labour charges, delays, vandalism, negligence, fouling caused by foreign material, damage from adverse water conditions, chemical, electrical or any other circumstances over which Galvin Engineering has no control. This warranty shall be invalidated by any abuse, misuse, misapplication, improper installation or improper maintenance or alteration of the product.

