

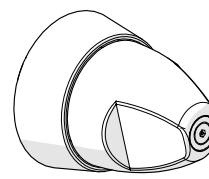

# Safe-Cell<sup>®</sup> Manual Prison Tapware

## PRODUCT CODES:

- 50117C    - 50133C
- 50120C    - 50138C



Ezy-Grip  
Handle

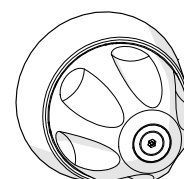

Multi-Grip  
Handle

## SPECIFICATIONS

- Designed for maximum protection against vandalism, Safe-Cell<sup>®</sup> Wall Top Assemblies are made from heavy duty components and feature rear installation. They are also designed to be ligature resistant for added safety.
- The wall top assemblies are made of chrome plated brass.
- Quarter turn ceramic disc.
- Machined cold or hot identification button.
- Anti-ligature design.
- Available with either Ezy-Grip or Multi-Grip handle (as shown above).

**IMPORTANT:** All Safe-Cell<sup>®</sup> Wall Top assemblies are tested in accordance with AS/NZS 3718 and leave our premises in good working order.

## TECHNICAL DATA

Inlet	G5/8" BSP - Male	
Outlet	N/A	
Headwork	Ceramic	
Working Pressure Range (kPa)	Min	50
	Max	500
Working Temperature (°C)	Min	5
	Max	85
Nominal Flow Rate (LPM)	N/A	
Finish	Chrome	

**NOTE:** Galvin Specialised continually strive to improve their products. Specifications may change without notice.

## PRE-INSTALLATION

### MOUNTING DETAILS

#### Wall body

- Measure the depth that the body is recessed into the wall,
- Wall body must be G5/8". If the depth is greater than 10mm
- then contact Galvin Specialised on 1300 514 074 for 20mm spindle extension (Item# 50190)

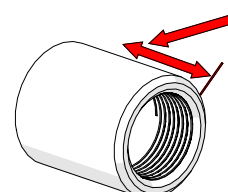

## TOOLS REQUIRED

- Spanner and hex key
- Thread tape



## INSTALLATION

**IMPORTANT:** Galvin Specialised products must be installed in accordance with these installation instructions and in accordance with AS/NZS 3500, the PCA and your local regulatory requirements. Water and/or electrical supply conditions must also comply to the applicable national and/or state standards. Failing to comply with these provisions shall void the product warranty and may affect the performance of the product.

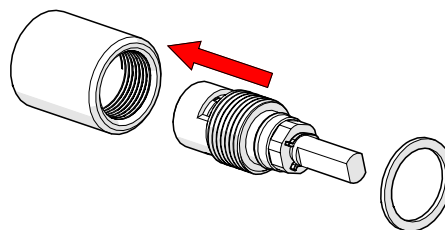
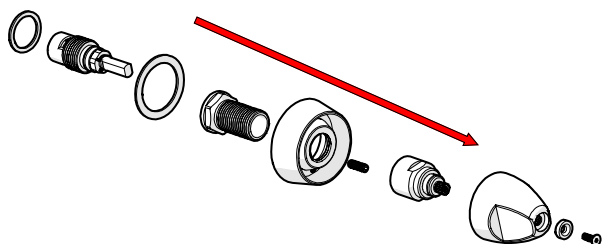

### 1. Disassembly

- Disassemble components
- Separate body washer, cartridge and locknut

### 2. Fit cartridge

- Fit ceramic cartridge in to the wall body. Fit body washer
- Do not over tighten and do not use spindle to tighten.

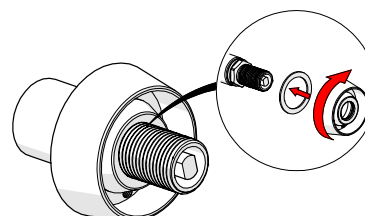
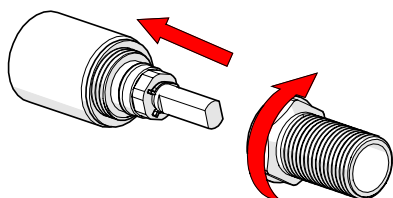

### 3. Fit locknut

- Fit locknut and tighten onto the cartridge, ensuring fiber washer seals have a similar tension to the conventional jumper valve headpart.

### 4. Fit dress flange

- Fit dress flange onto the locknut and tighten.

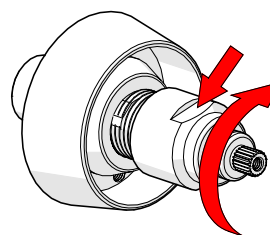
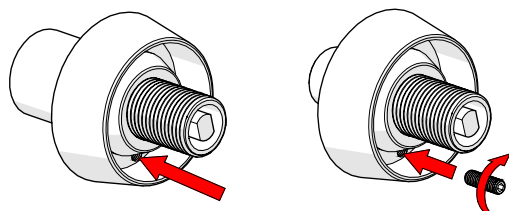

### 5. Fit dress flange with anti-rotation pin

- If the anti-rotation option is required, fit dress flange onto locknut and mark the wall. Remove the flange and drill 3/16" hole 10mm deep.
- Replace the flange and screw in the grub screw to lock.

### 6. Fit lock sleeve

- Fit lock sleeve and tighten to lock entire unit in position.

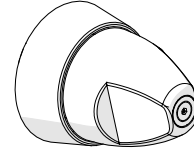
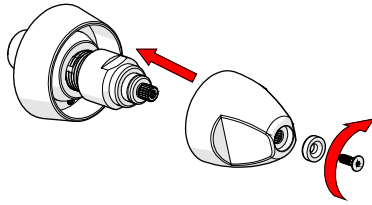

### 7. Assemble handle

- Fit handle with tamper proof screw, ensure the correct water temperature identification button is in the handle
- Screw must be tightened before the unit is tested

### 8. Testing

- Once temperature indicator is fitted, check the operation of the unit and inspect for any leaks.

## TROUBLESHOOTING

PROBLEM	CAUSE	RECTIFICATION
Taps are dripping water	Ceramic cartridge is worn or damaged	Remove and inspect the cartridge, remove debris and /or replace cartridge if damaged
Water is not flowing from tap	Water is turned off	Turn on water

## WARRANTY

The warranty set forth herein is given expressly and is the only warranty given by the Galvin Engineering Pty Ltd. With respect to the product, Galvin Engineering Pty Ltd makes no other warranties, express or implied. Galvin Engineering Pty. Ltd. hereby specifically disclaims all other warranties, express or implied, including but not limited to the implied warranties of merchantability and fitness for a particular purpose.

Galvin Engineering Pty Ltd products are covered under our manufacturer's warranty available for download from [www.galvinengineering.com.au](http://www.galvinengineering.com.au) Galvin Engineering Pty Ltd expressly warrants that the product is free from operational defects in workmanship and materials for the warranty period as shown on the schedule in the manufacturer's warranty. During the warranty period, Galvin Engineering will replace or repair any defective products manufactured by Galvin Engineering without charge, so long as the terms of the Manufacturer's warranty are complied with.

The remedy described in the first paragraph of this warranty shall constitute the sole and exclusive remedy for breach of warranty, and Galvin Engineering Pty Ltd shall not be responsible for any incidental, special or consequential damages, including without limitation, lost profits or the cost of repairing or replacing other property which is damaged if this product does not work properly, other costs resulting from labour charges, delays, vandalism, negligence, fouling caused by foreign material, damage from adverse water conditions, chemical, electrical or any other circumstances over which Galvin Engineering has no control. This warranty shall be invalidated by any abuse, misuse, misapplication, improper installation or improper maintenance or alteration of the product.

