

Ezy-Drink® Lead Free Remote Bubbler Tapware

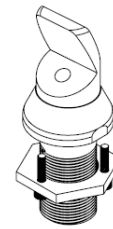

PRODUCT CODES:

- 85333X

SPECIFICATIONS

- Lead Free stainless steel construction

IMPORTANT: All Ezy-Drink® remote bubbler taps are tested in accordance with AS/NZS 3718 and leave our premises in good working order.

Inlet	1/2" BSP - Female	
Outlet	Metal Mouthguard	
Headwork	N/A	
Working Pressure Range (kPa)	Min	30
	Max	1000
Working Temperature Range (°C)	Min	2
	Max	65
Nominal Flow Rate (LPM)	N/A	

TOOLS REQUIRED

- Power drill
- Wrench
- 2mm Hex Key (provided)
- Screwdriver

PRE-INSTALLATION - MOUNTING DETAILS

- If the mounting holes do not already exist, mark out and drill the holes in the bench/trough, as shown in rough-in dimensions.

Note: Before installation, all lines must be flushed. We recommend that a line strainer be installed prior to drinking taps to eliminate any foreign material.

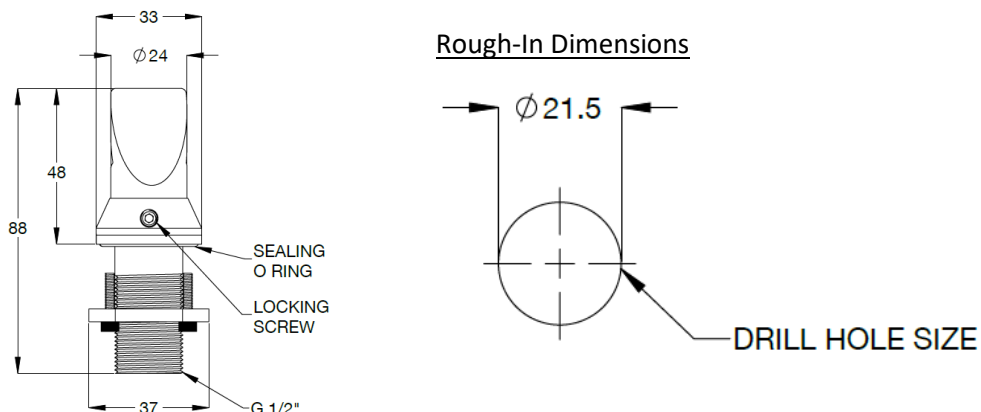

INSTALLATION

IMPORTANT: Galvin Engineering products must be installed in accordance with these installation instructions and in accordance with AS/NZS 3500, the PCA and your local regulatory requirements. Water and/or electrical supply conditions must also comply to the applicable national and/or state standards. Failing to comply with these provisions shall void the product warranty and may affect the performance of the product.

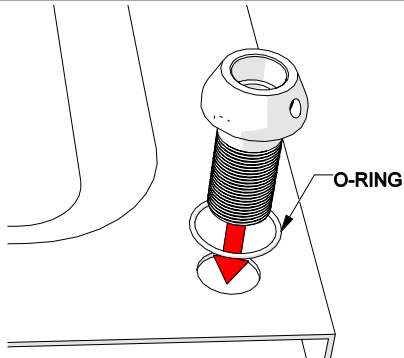

1. Mounting Stem

- Drill hole in bench/trough as shown in rough-in dimensions.
- Fit O-Ring to the groove underneath the stem.
- Insert stem through the drilled hole ensuring the O-Ring has seated properly.

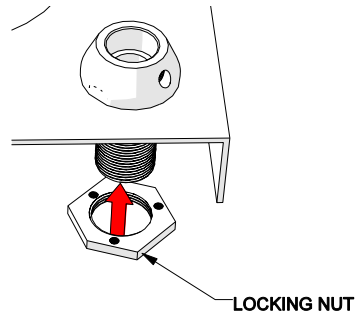

2. Fit Locking Nut

- Fit and Tighten locking nut until it stops (roughly 8mm below the bench/trough).

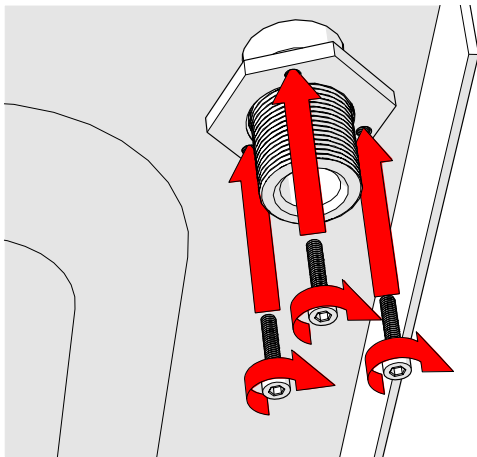

3. Fit thumb screws

- Fit thumb screws into the threaded holes on the locking nut and tighten until the stem is securely mounted on the bench/trough.

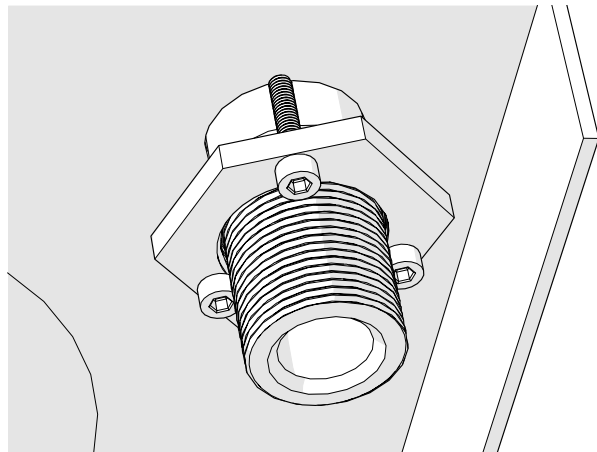

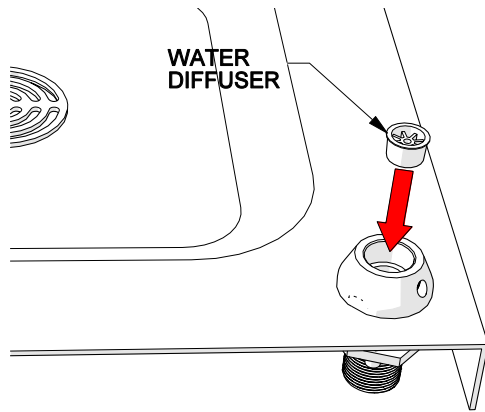

5. Fit water diffuser

- Fit water diffuser into stem ensuring that it is seated correctly.

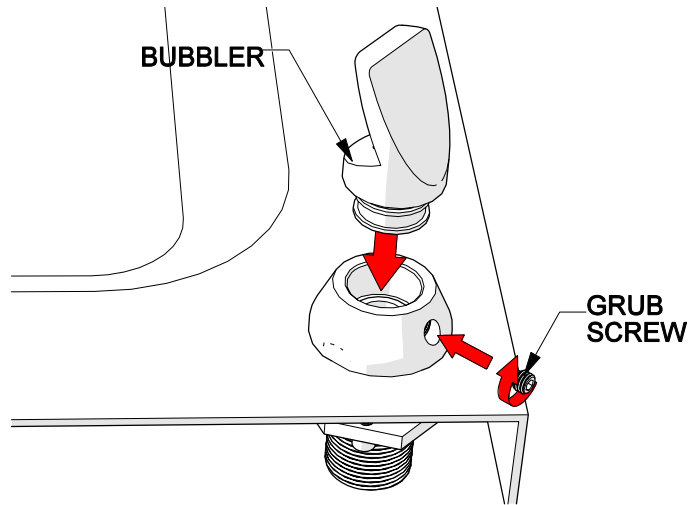

6. Fit Bubbler

- Fit bubbler into stem ensuring it is seated correctly.
- Turn the bubbler to the desired position.
- Once positioned, fit and tighten grub screw. The bubbler should no longer turn.

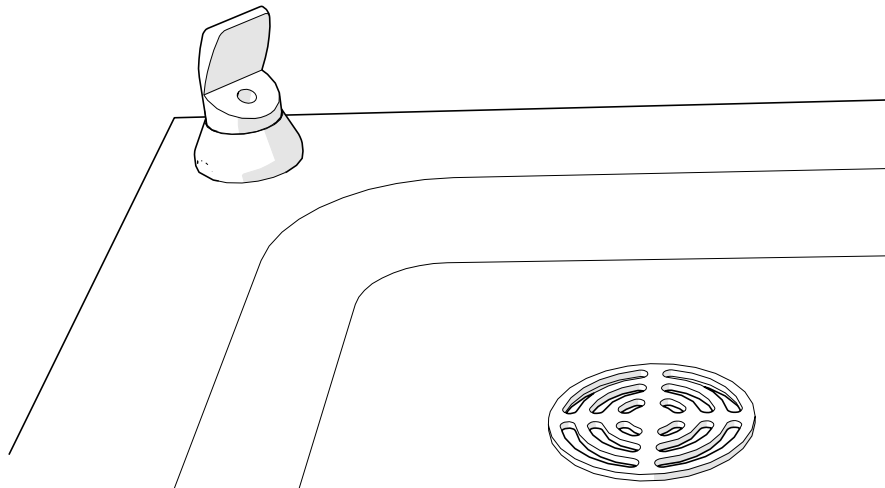

7. Test

- Test installation and check for leaks.

Product Installation Guideline

TROUBLESHOOTING		
PROBLEM	CAUSE	RECTIFICATION
Inconsistent flow	Blocked top assembly	Remove top assembly and clean
Water is not flowing from bubbler	Water is turned off	Turn on water
Installation is leaking	Incorrectly installed	Disassemble and follow the installation instructions above ensuring the O-Rings are positioned correctly.
Installation loose	Locking screws underneath haven't been adequately tightened.	Follow step 3 of the installation guide and ensure the screws are tight enough to avoid movement of the installation.

WARRANTY

The warranty set forth herein is given expressly and is the only warranty given by the Galvin Engineering Pty Ltd. With respect to the product, Galvin Engineering Pty Ltd makes no other warranties, express or implied. Galvin Engineering Pty. Ltd. hereby specifically disclaims all other warranties, express or implied, including but not limited to the implied warranties of merchantability and fitness for a particular purpose.

Galvin Engineering Pty Ltd products are covered under our manufacturer's warranty available for download from www.galvinengineering.com.au Galvin Engineering Pty Ltd expressly warrants that the product is free from operational defects in workmanship and materials for the warranty period as shown on the schedule in the manufacturer's warranty. During the warranty period, Galvin Engineering will replace or repair any defective products manufactured by Galvin Engineering without charge, so long as the terms of the Manufacturer's warranty are complied with.

The remedy described in the first paragraph of this warranty shall constitute the sole and exclusive remedy for breach of warranty, and Galvin Engineering Pty Ltd shall not be responsible for any incidental, special or consequential damages, including without limitation, lost profits or the cost of repairing or replacing other property which is damaged if this product does not work properly, other costs resulting from labour charges, delays, vandalism, negligence, fouling caused by foreign material, damage from adverse water conditions, chemical, electrical or any other circumstances over which Galvin Engineering has no control. This warranty shall be invalidated by any abuse, misuse, misapplication, improper installation or improper maintenance or alteration of the product.